

PUZ / A3/6.

ZONIFICARE FUNCTIONALA REGLEMENTARI URBANE - RESTRICTII SI PERMISIUNI

SCARA 1 : 1000
SUPRAFATA TOTALA ZONA STUDIATA = 4,73 ha

LEGENDA

| | |
|--|--|
| LIMITA ZONA STUDIATA | |
| LIMITA PROPRIETATE CE A GENERAT PUZ | |
| ID + IS ZONA INDUSTRIE SI DEPOZITARE , INSTITUTII , SERVICII , COMERT | |
| SV ZONA VERDE , SCUARURI , RECREERE | |
| ZONA CIRCULATIE CAROSABILA PRINCIPALA | |
| CONTUR EDIFICABIL | |
| ALINIAMENT CONSTRUCTII | |
| ZONA CU INTERDICTIE DE CONSTRUIRE REZERVATA STRAZI PROPUSE IN PUG PRELIMINAR MUN. BUZAU | |

SUPRAFATA TEREN PROPRIETATE RAICU IONUT MARIUS & RAICU MIRELA = 1500 m²
P.O.T. MAX. PROPUSS 60 %
C.U.T. MAX. PROPUSS 1,8
REGIM MAX. INALTIME P + 2E

BILANT TERITORIAL PROPUSS

| ZONE FUNCTIONALE | PROPUS | |
|--|--------|-------|
| | ha | % |
| 1 ZONA CIRCULATIE CAROSABILA PRINCIPALA | 0,942 | 19,9 |
| 2 ID + IS ZONA INDUSTRIE SI DEPOZITARE , INSTITUTII SERVICII , COMERT | 3,697 | 78,2 |
| 3 SV ZONA VERDE , SCUARURI , RECREERE | 0,091 | 1,9 |
| TOTAL | 4,730 | 100,0 |



SC SIGNUM SRL BUZAU
B - DUL UNIRII / BL. C2 / APT. 14
TEL. 0238.414896
CSM 0722777315
NR. REG. COM. J10/722/06.12.2002
COD U.I.F. 15070306

| | |
|-------------|------------------|
| SEF PROIECT | ARH. DANIEL POPA |
| PROIECTAT | ARH. DANIEL POPA |
| DESENAT | ARH. DANIEL POPA |

OBIECTIV: **PUZ - CONSTRUIRE HALA DEPOZITARE CU SEDIU
ADMINISTRATIV SI SPATIU DE VANZARE**

AMPLASAMENT: MUN. BUZAU / JUD. BUZAU / T37 / P682/1

BENEFICIAR: RAICU IONUT MARIUS & RAICU MIRELA

| | | | |
|----------|----------|--|--------------------------|
| DATA | SCARA | PROIECT NR. S 101.24 / PUZ | FAZA: |
| IAN 2024 | 1 / 1000 | TITUL PLANSEI REGLEMENTARI - RESTRICTII SI PERMISIUNI ZONIFICARE FUNCTIONALA | P.U.Z. PL. NR. A 3 |

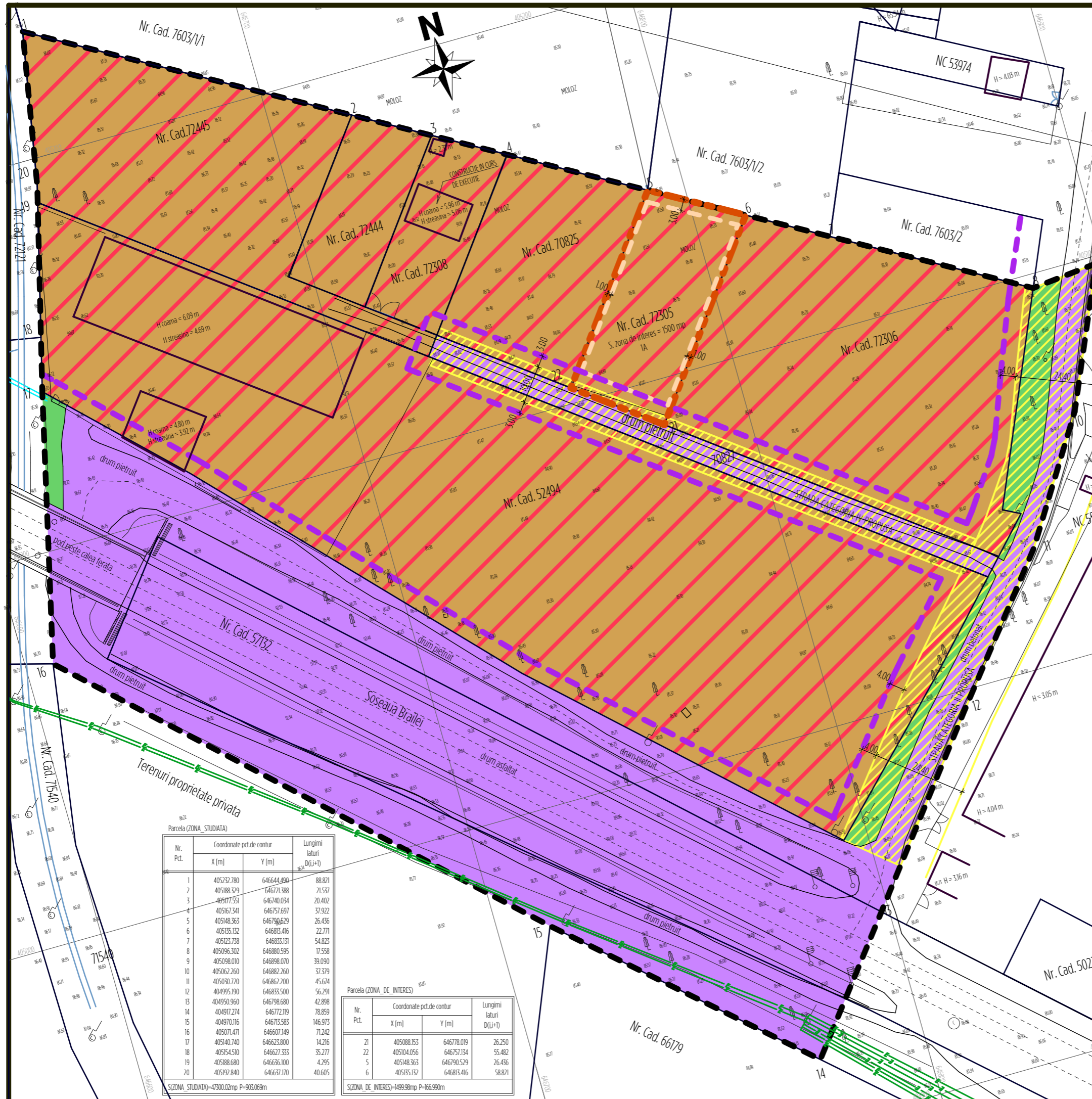

Parcela (ZONA STUDIATA)

| Nr. Pct. | Coordonate pct.de contur | | Lungimi laturi D(i,j+1) |
|----------|--------------------------|------------|-------------------------|
| | X [m] | Y [m] | |
| 1 | 405232.780 | 646644.490 | 88.821 |
| 2 | 405188.329 | 646721.388 | 21.537 |
| 3 | 405177.551 | 646740.034 | 20.402 |
| 4 | 405167.341 | 646757.697 | 37.922 |
| 5 | 405148.363 | 646790.629 | 26.436 |
| 6 | 405135.132 | 646813.416 | 22.771 |
| 7 | 405123.738 | 646833.131 | 54.823 |
| 8 | 405096.302 | 646880.595 | 17.558 |
| 9 | 405098.010 | 646898.070 | 39.090 |
| 10 | 405062.260 | 646882.260 | 37.379 |
| 11 | 405030.720 | 646862.200 | 45.674 |
| 12 | 404995.190 | 646833.500 | 56.291 |
| 13 | 404950.960 | 646798.680 | 42.898 |
| 14 | 404917.274 | 646772.119 | 78.859 |
| 15 | 404970.116 | 646713.583 | 146.973 |
| 16 | 405071.471 | 646607.149 | 71.242 |
| 17 | 405140.740 | 646623.800 | 14.216 |
| 18 | 405154.510 | 646627.333 | 35.277 |
| 19 | 405188.680 | 646636.100 | 4.295 |
| 20 | 405192.840 | 646637.170 | 40.605 |

SCZONA STUDIATA=4730.02mp P=903.069m

Parcela (ZONA DE INTERES)

| Nr. Pct. | Coordonate pct.de contur | | Lungimi laturi D(i,j+1) |
|----------|--------------------------|------------|-------------------------|
| | X [m] | Y [m] | |
| 21 | 405088.153 | 646778.019 | 26.250 |
| 22 | 405104.056 | 646757.134 | 55.482 |
| 5 | 405148.363 | 646790.529 | 26.436 |
| 6 | 405135.132 | 646813.416 | 58.821 |

SCZONA DE INTERES=1499.98mp P=166.990m